

# Pfaff 939 Subclass

# PFAFF

## 939

Unterklassen-Ausstattung

Subclass parts

Composition des sous-classes

Composición de las subclases

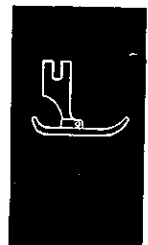

Table of subclasses  
Table des sous-classes  
Tabla de subclases

PFAFF 939



Unterklasse Subclass Sous-classe Subclase	-6/01 (-900/...)	-32/23 (-900/...)
Arbeitsgang Operation Opération Operación	Für allgemeine Näharbeiten. Standardform des Teilesatzes. For ordinary sewing operations. Standard parts set. Travaux d'utilité courante. Jeu de pièces standard. Para trabajos de costura en general. Juego de piezas estándar.	
Ausführung Model Version Tipo de máquina	AB	BN 24
Überstichbreite in mm Stitch width in mm Jetée de l'aiguille en mm Anchura del zigzag en mm	6,0	6,0
Nadelstange Needle bar Barre à aiguille Barra de aguja	91-168 019-91	91-168 019-91
Nähfuß <sup>[4]</sup> Presser foot Pied presseur Pie prensatelas	91-054 695-23	91-157 299-93
Stichplatte <sup>[4]</sup> Needle plate Plaque à aiguille Placa de aguja	91-058 034-24	91-058 113-24
Stoffschieber <sup>[4]</sup> Feed dog Griffe Transportador inferior	91-047 381 03	91-047 746-03
Apparat <sup>[5]</sup> Attachment Appareil Aparato		91-050 946-23
Träger Bracket Support Soporte		91-753 936-90

Table des sous-classes  
Tabla de subclases

PFAFF 939

Unterklasse Subclass Sous-classe Subclase	-65/23 (-900/..)	-771/04-6/27 (-900/..)	-771/04-280/06 (-900/..)
Arbeitsgang Operation Opération Operación			
Ausführung Model Version Tipo de máquina	BN 24	AN 13	AN 13
Überstichbreite in mm Stitch width in mm Jetée de l'aiguille en mm Anchura del zigzag en mm	6,0	3,0	3,0
Nadelstange Needle bar Barre à aiguille Barra de aguja	91-168 019-91	91-168 019-91	91-168 019-91
Nahfuß [4] Presser foot Pied presseur Pie prensatelas	91-155 047-91	91-155 954-03	91-154 195-91
Stichplatte [4] Needle plate Plaque à aiguille Placa de aguja	91-058 113-24	91-150 168-93	91-150 168-93
Stoffschieber [4] Feed dog Griffe Transportador inferior	91-047 746-03	91-059 787-03	91-059 787-03
Lineal Edge guide Guide-droit Guia recta	91-053 620-70/895		
Träger Bracket Support Soporte			91-187 247-70/893 91-167 298-71/895

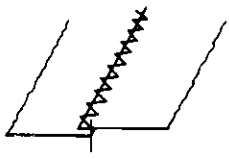
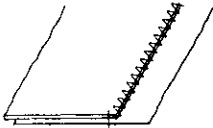

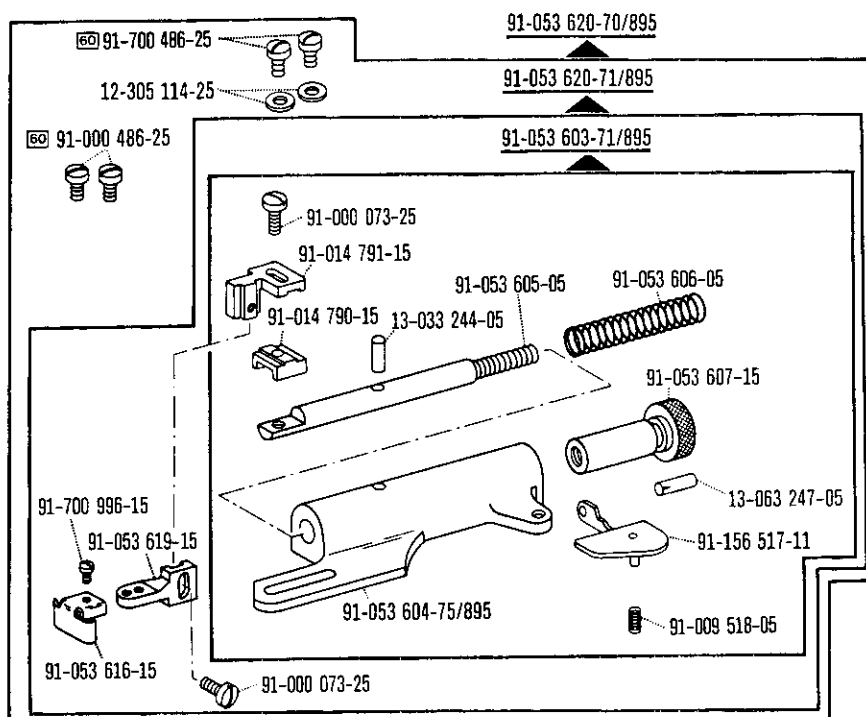

-65/23 (-900/..)

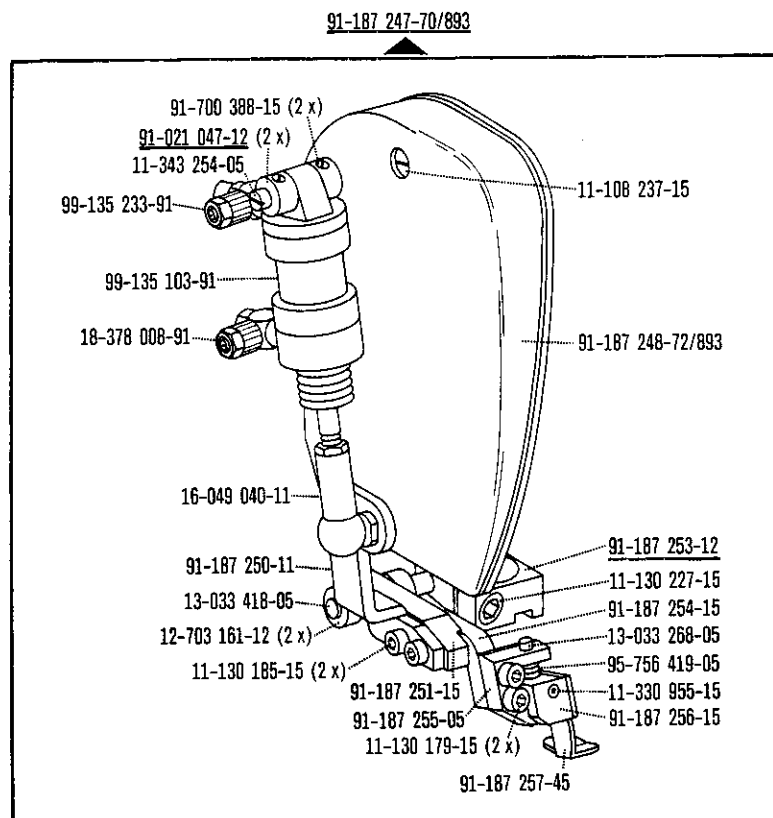

-771/04-280/06 (-900/..)

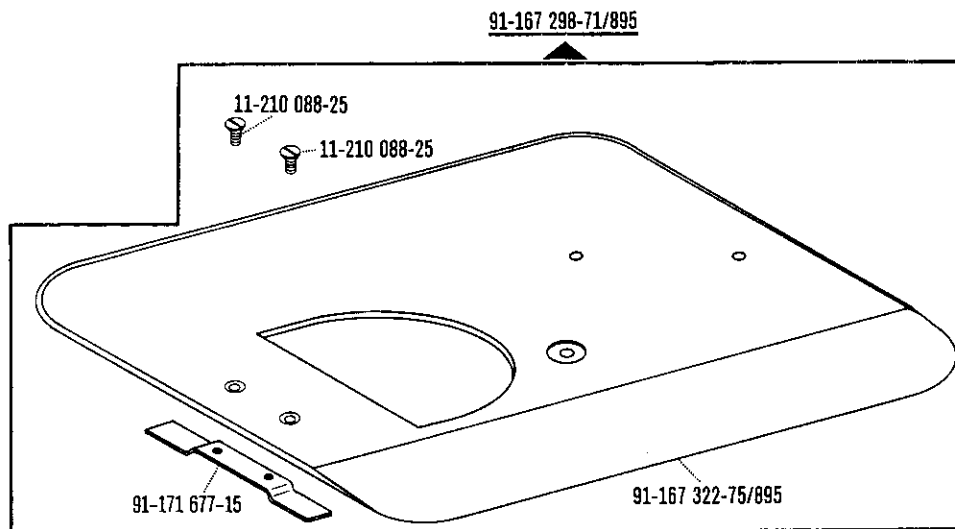

-771/04-280/06 (-900/..)

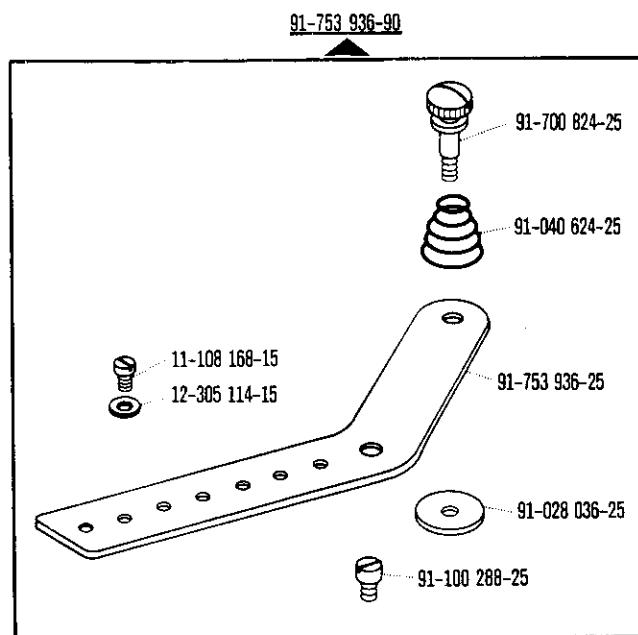

-32/23 (-900/..)